

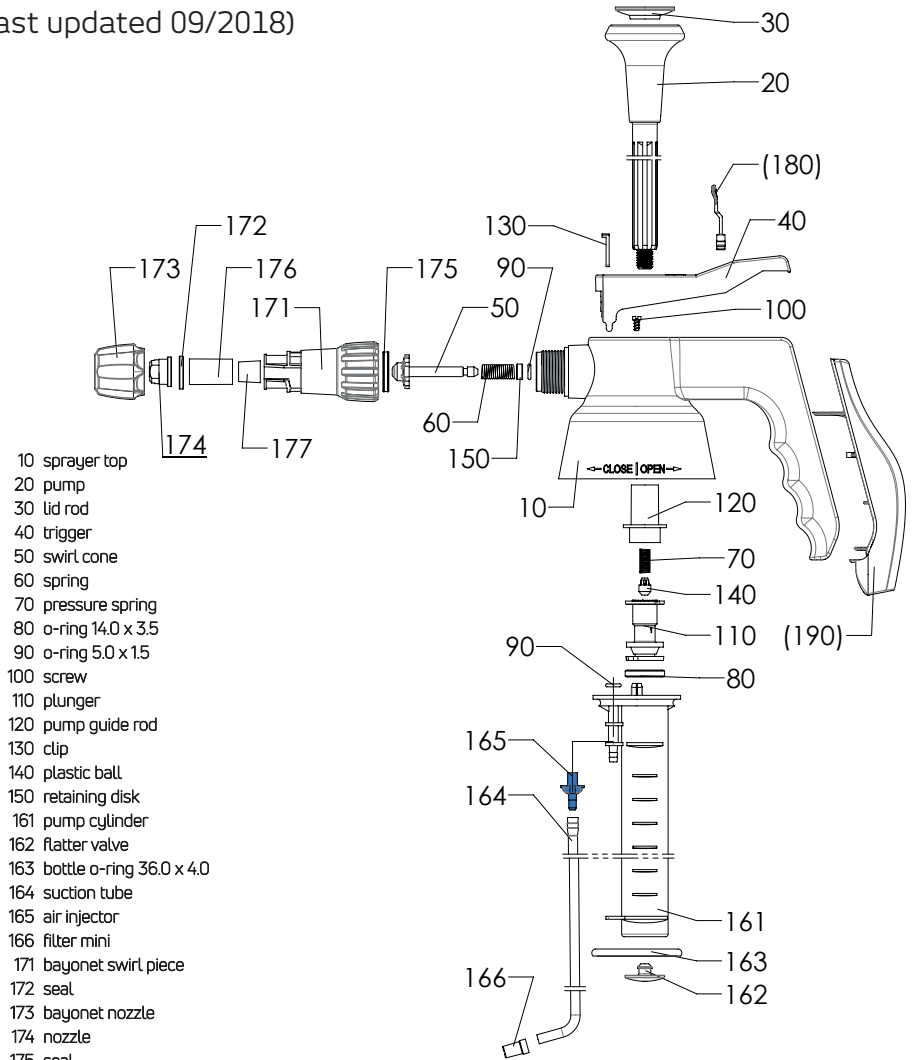

EasyPump Foam | Pump spray bottle for application foam

Spare Parts Operating instructions for Compressed Air Sprayers

Article-No YT20EPF150
(last updated 09/2018)



- 10 sprayer top
- 20 pump
- 30 lid rod
- 40 trigger
- 50 swirl cone
- 60 spring
- 70 pressure spring
- 80 o-ring 14.0 x 3.5
- 90 o-ring 5.0 x 1.5
- 100 screw
- 110 plunger
- 120 pump guide rod
- 130 clip
- 140 plastic ball
- 150 retaining disk
- 161 pump cylinder
- 162 flatter valve
- 163 bottle o-ring 36.0 x 4.0
- 164 suction tube
- 165 air injector
- 166 filter mini
- 171 bayonet swirl piece
- 172 seal
- 173 bayonet nozzle
- 174 nozzle
- 175 seal
- 176/177 foam sleeve with felt
- (180) safety/continuous spray function
- (190) ErgoGrip

Congratulations on the acquisition of your new Compressed Air Sprayer. We thank you for your trust in our products. Please read the operating instructions carefully before using the device, and keep them in a safe place. If the device is passed on to a third party, it is imperative that these instructions also be passed on with it.

Preparation

- Check before use that all parts are undamaged and working correctly.
- Unscrew the pump from the tank.
- Fill about half of the bottle with liquid. With the EasyPump Foam range of pressure sprayers, it is essential to have a larger pressure cushion to achieve a longer spraying time.
- Screw the pump head on and tighten it so that the canister is sealed and airtight (if it is not, it will be impossible for pressure to build up).

Usage

- Pump air into the tank using the piston (around 20 to 40 pump movements, depends on bottle size). Please note: the best foam result can only be realized with full pressure. Important: It is not possible to generate more pressure in the tank than specified. The sprayers are fitted with an **automatic relief valve**.
- Press the spray button to spray.
 - On models with a **safety function**, the safety button must be pulled back before the spray button can be pressed.
 - On models with **continuous spraying function**, use the lever and engage the arresting knob by pushing it forward. The continuous spray function is deactivated again by pulling back the arresting knob or by actuating the spray lever.
- If liquid drips out of the nozzle after releasing the spray button, there is still air in the atomiser. Spray diagonally upwards for approx. two to three seconds to allow air to escape. A uniform and perfect foam pattern requires a clean foaming agent. Mix chemicals and water thoroughly prior to filling. Please note the usage instructions of the chemical manufacturer.

After usage

- Once you have finished spraying, unscrew the spray head slowly to allow the pressure to escape. Please note that foam can escape while the container is opened.
- Do not pour residues into drains; instead, dispose of them in accordance with the instructions of the manufacturer of the liquid. Then clean the pump by using it to spray clean water or a suitable cleaning agent.
- Rinse the sleeve with felt thoroughly in order to prevent sticking.

Safety

- Never leave the tank in a pressurised state for long periods of time.
- Do not expose the Compressed Air Sprayer to direct sunlight.
- Do not fill any hot liquids exceeding 30° Celsius.
- Only change the Coding Cap when sprayer is not in a pressurised state.
- Note the safety data sheet of the liquid's manufacturer.
- Never aim the sprayer at people or animals.
- The manufacturer is not liable for damage caused by incorrect usage or unauthorised modifications of the device.

Maintenance and care

- Oil the pump piston from time to time (see symbol on the spray button). In the case of sprayers with EPDM seals, please only use silicone oil/greases for lubrication.
- Check that the nozzle and filter at the end of the suction tube is free of deposits. Use compressed air to clean the nozzle or filter if it is blocked.
- If a part is visibly damaged or worn, replace it. Only use original parts.
- Spare parts and sets of seals can be obtained from your supplier or dealer.

The EasyPump Foam has three different sleeves with inserted felts. The standard sleeve is already installed in the foam nozzle. The other two sleeves are used to individually adjust the foam pattern depending on the liquid used and the desired degree of foam.

Only liquids suitable for foaming can be applied with the sprayer.

Foam nozzle components

- Nozzle head mounted with sleeve incl. inlaid Snow Foam felt
- 2 additional sleeves with alternative felts
- Air injector (part no. 165, located on the suction tube part no. 164)



Foam pattern adjustment

- Unscrew the bayonet nozzle at the front
- Remove and replace the felt sleeve
- Screw on the bayonet nozzle



Please note:
the triangle must
point forwardn

Nozzle alignment adjustment

- Unscrew the bayonet nozzle at the front
- Turn the coloured flat spray nozzle to the desired position
- Screw on the bayonet nozzle, hold the flat spray nozzle in the desired position in the process



Foaming levels

Snow Foam
solid foam

(Delivery status)

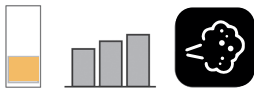

sleeve foaming level foam pattern

Mousse Foam
medium foam

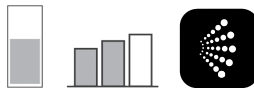

sleeve foaming level foam pattern

Hydro Foam
liquid foam

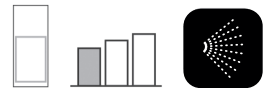

sleeve foaming level foam pattern

The modification to a flat jet sprayerr

The compressed air sprayer Foam can be modified easily from a foam sprayer to a flat jet sprayer:

- Screw off the foam nozzle swirl piece, take out the sleeve including inlaid felts and screw on the nozzle swirl piece
- Screw off the complete pump head and take out the blue air injector from the upper suction tube end.

Do you have any further questions? Feel free to contact us!
Tel: +49 2292 397400 or send an email to sales@yellotools.com

www.yellotools.com